

PRINCIPAL PARTICULARS

LOH: 11.5m (HULL ONLY)
 BEAM: 4.35m
 DEPTH: 2.3m
 DRAFT: 0.475m (HULL)
 D/RISE: 12°
 DISPL: 7500KG
 ENG: 2x 200-350HP

11.5m POWER CAT
 GENERAL ARRANGEMENT

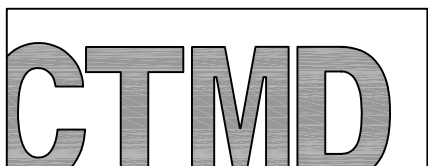
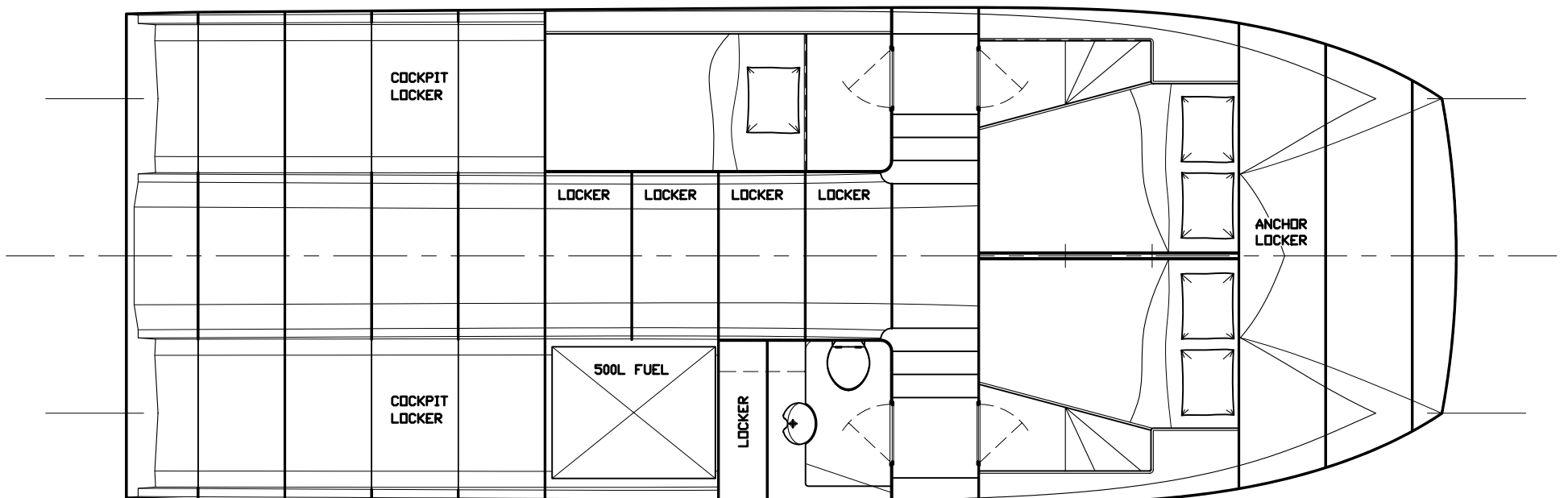
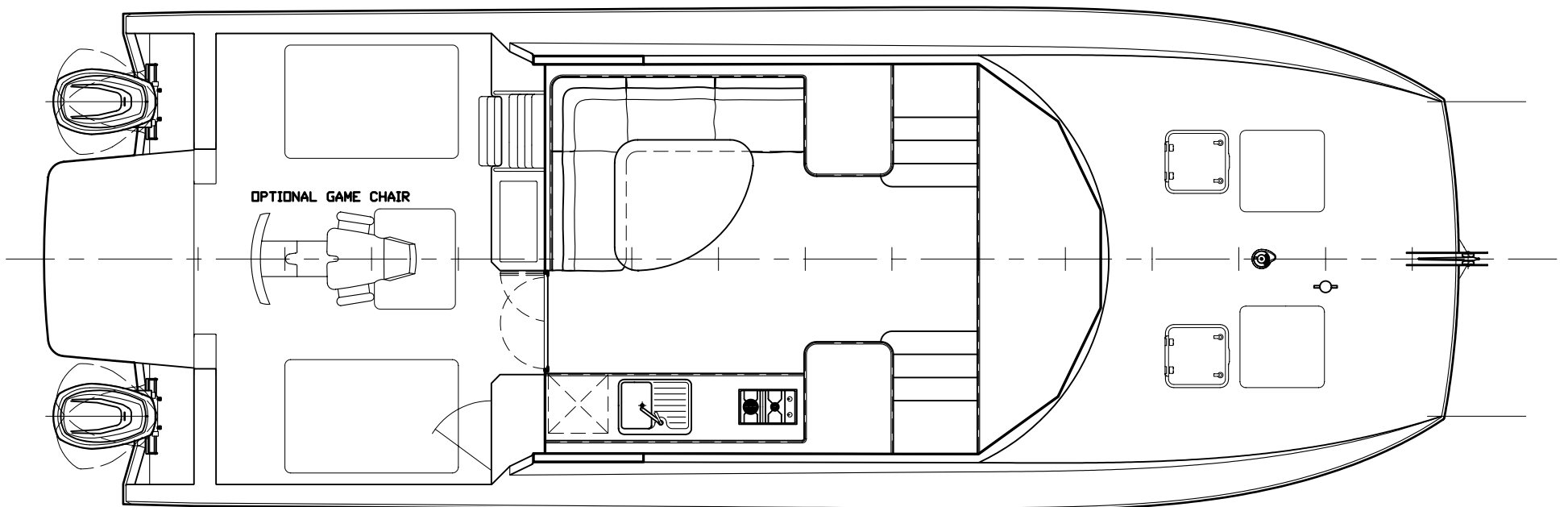
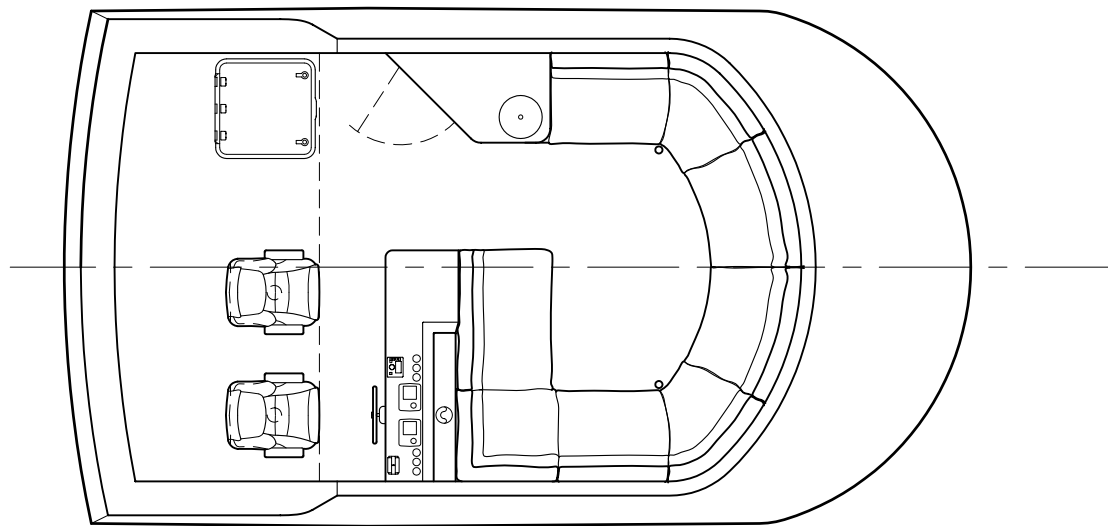
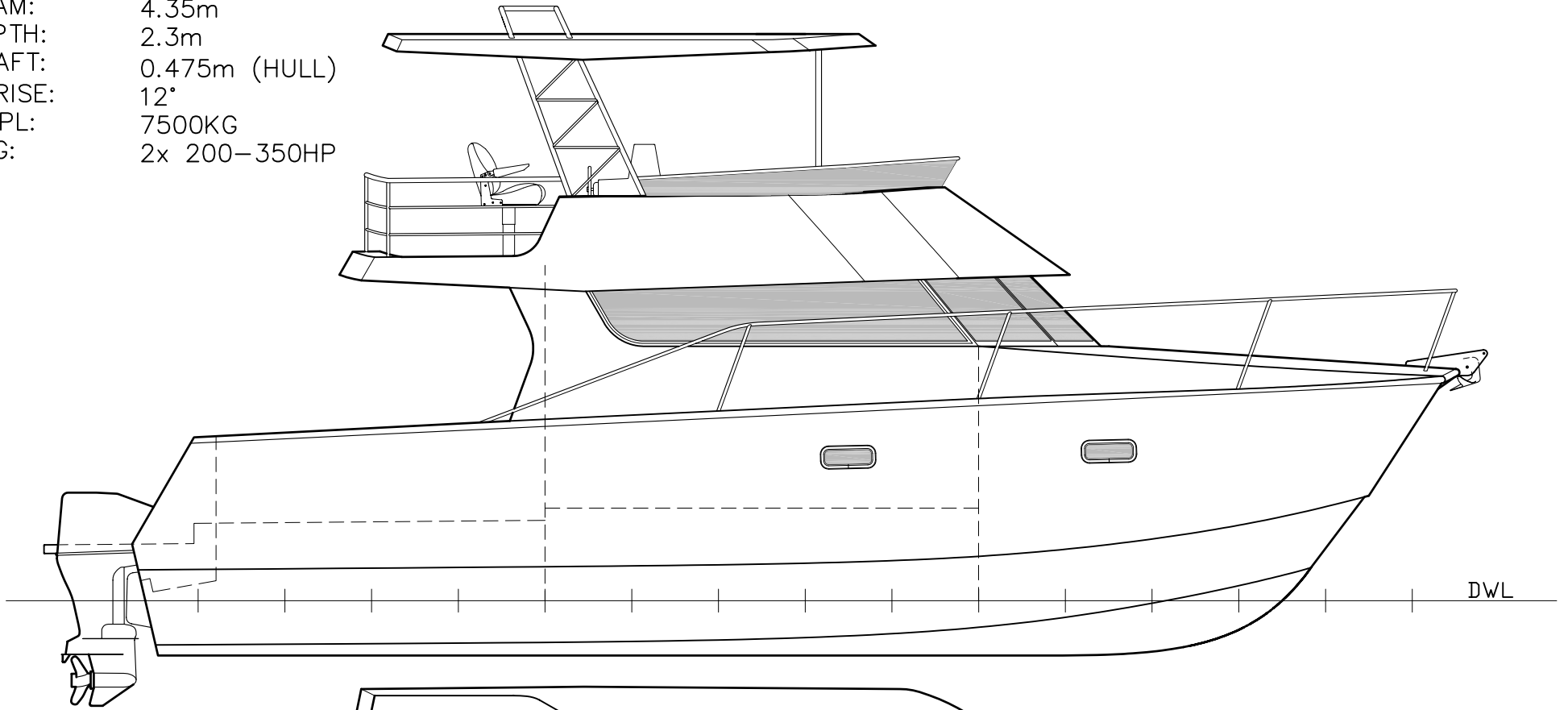

Kit Notes: Launcher, Fuel Tanks, Bow rail and anchor gear not included in Flat Pack Kit

This drawing is the property of CTMD 31 Perrins Creek Road Olinda, Victoria, Australia - Phone: 0400 628 379 - www.ctmd.com.au

